

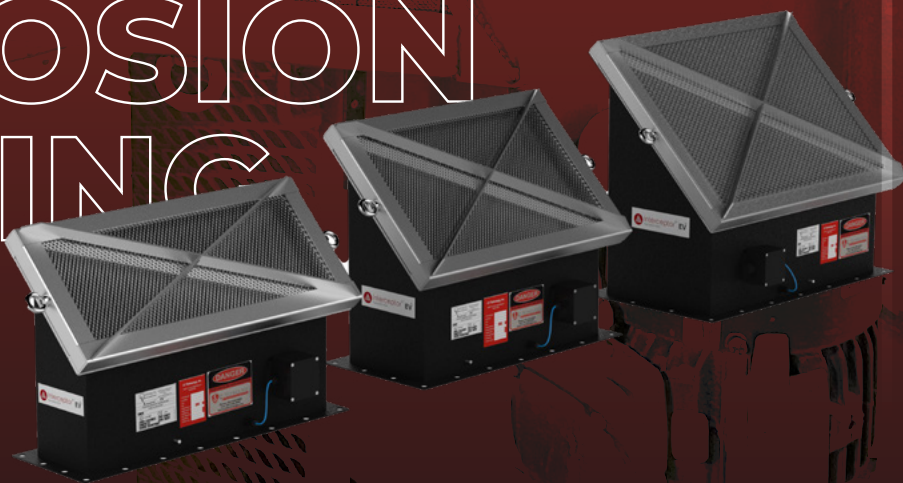

GV TECHNOLOGY®
FIRE AND EXPLOSION PROTECTION

EV

FLAMELESS
EXPLOSION
VENTING



The Interceptor-EV is designed to be a passive, flameless venting solution for conveyors and bucket elevators.

The flame arresting design eliminates the possibility of a flame traveling into occupied areas and process equipment. The Interceptor-EV is comprised of two parts, a rectangular explosion vent and a quencher. The quencher consists of two cartridges, assembled with various layers of stainless steel mesh that absorbs the flame and hot gases during a combustion event.

During a deflagration the quencher takes over to absorb the heat from the flame and hot gases. The mesh acts as a heat sink to quench the temperature and break the chain reaction, effectively interrupting the explosion during development. As the hot gases contract the Interceptor-EV acts as a vacuum breaker by allowing free entry of cool air to achieve equilibrium in the protected vessel.



**NFPA 68
Compliant**



**EN 16009
Certified**

FEATURES

**Integrated
burst indicator**

**Access door for
vent inspection**

**Field
refurbishable**

**TLFG explosion
vent standard**



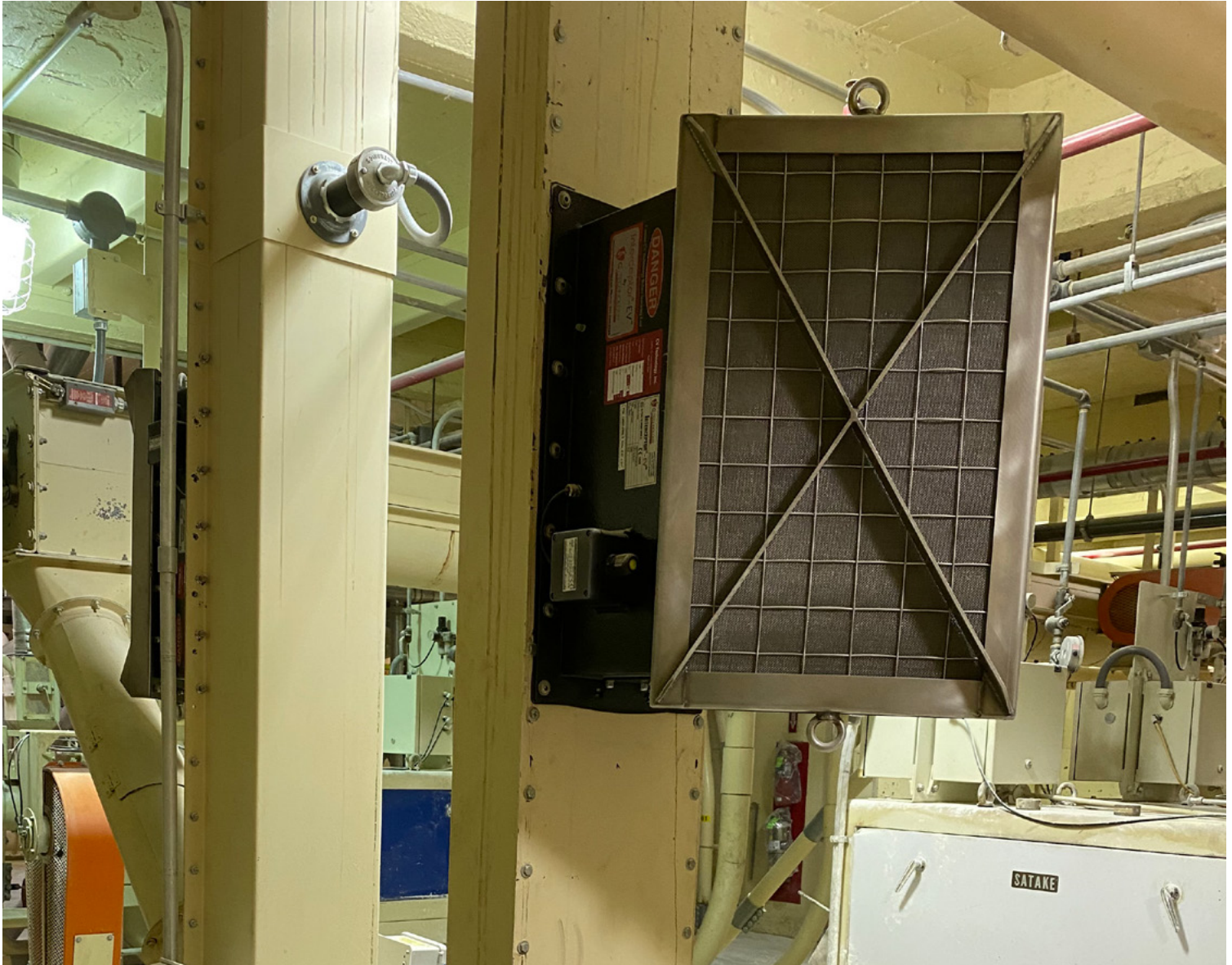

Options:

- Dust Covers
- Burst Pressures varying from 0.05 bar to 0.1 bar
- Multiple Gaskets
- Class II, Division I
- Relay Module Option

Applications:

- Bucket Elevators
- Conveyors
- Small Vessels
- All materials except metals



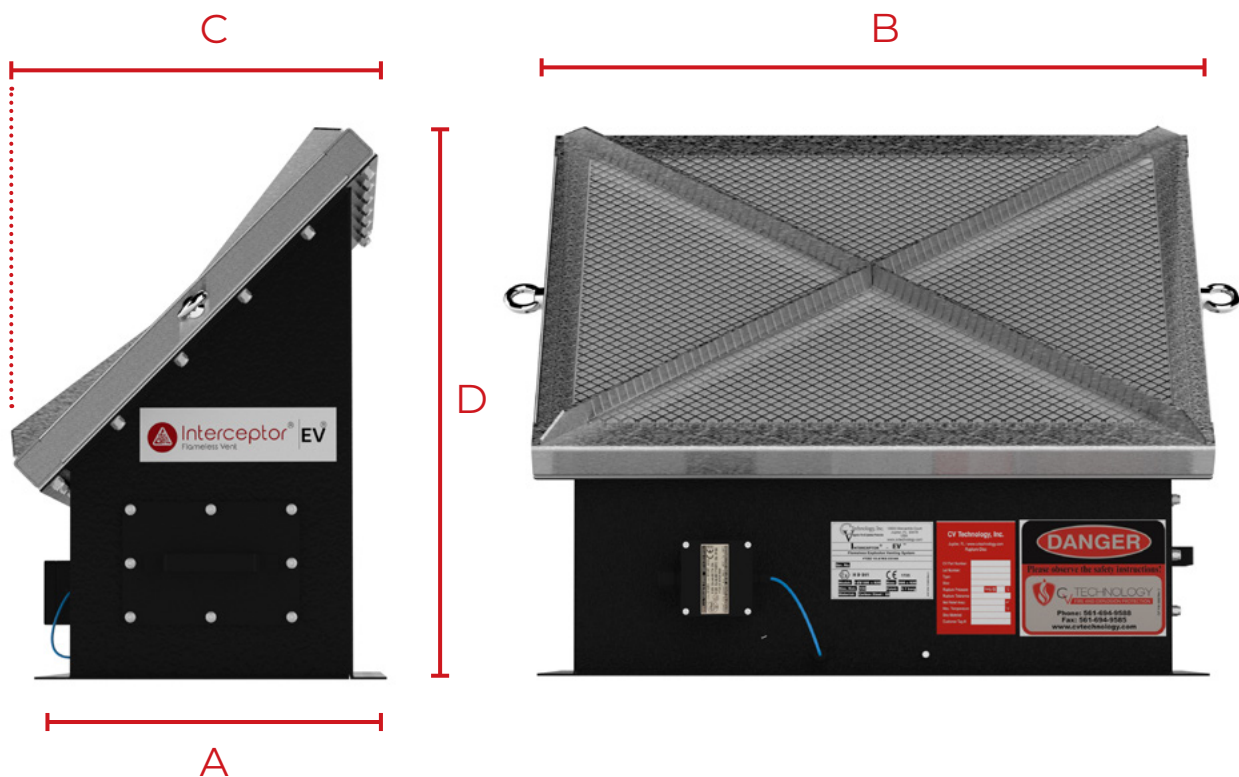

WEIGHT & DIMENSION

Size	A Inch (mm)	B Inch (mm)	C Inch (mm)	D Inch (mm)	Weight Lbs (kg)
6"x24" (150x600)	8.9" (225)	26.6" (675)	10.4" (265)	18.3" (465)	53 lbs (24)
8"x22" (200x540)	12.0" (305)	24.6" (625)	13.2" (335)	20.9" (530)	62 lbs (28)
12"x24" (310x630)	15.4" (390)	28.0" (710)	16.5" (420)	24.4" (620)	77 lbs (35)

SPECIFICATIONS



	Description
Compliance and Certifications:	NFPA 68 ATEX, EN 16009 Certified
Materials of Construction:	Painted Carbon Steel and Stainless-Steel Mesh
Explosion Vents	TLFG: Triple Layer Composite consisting of 304 SS (1.4301) and PTFE
Burst Pressures:	Standard: 0.1 bar (1.5 PSI) Tolerance: (+/-15%) 0.085 to 0.115 bar (1.2 to 1.6 PSI) @ 22°C (72 °F) Other CV Technology explosion vents may be used. Please contact the factory for alternatives.
Gasket Material	Standard: Black EDPM Gasket Optional: White FDA Buna Nitrile
Signaling:	External Wire Sensor and Junction Box
Environmental Conditions:	Ambient Pressure and Temperatures Ranges: -4°C to 140°C (-20°C to 60°C)
Process Temperature:	Standard specs for TLFG Other CV Technology explosion vents may be used. Please contact the factory for alternatives.
Hazard:	$K_{st} \leq 220$ bar-m/s Maximum Pred = 0.4 bar (9.42 PSI) Compliant with Organic, Melting, Fibrous, Some Metal Dusts
Safe Distances:	6" x 24" EV: 2.5 ft (0.75 m) from personnel, 1.6 ft (0.5 m) from equipment 8" x 22" EV: 3.3 ft (1.00 m) from personnel, 1.6 ft (0.5 m) from equipment 12" x 24" EV: 3.3 ft (2.00 m) from personnel, 1.6 ft (0.5 m) from equipment Contact CV Technology for application safe distances.



Contact us for more info!

15852 Mercantile Court
Jupiter, Florida 33478

Tel : 561.694.9588
Fax : 561.694.9585

info@cvtechnology.com

www.cvtechnology.com

